

# G100CLOSURE

ROOF AND WALL CLOSURE SYSTEMS

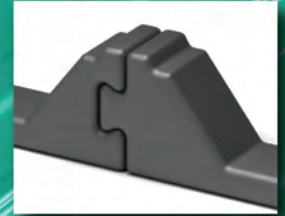

**ATLAS**  
CLOSURE  
**INTER-LOK**  
SYSTEM



- *Available in G-100 and S-100 Material*
- *Eliminates gapping and stretching for quick, easy installation!*
- *Effective in harsh weather conditions!*
- *Adhesive bead available for a snug fit!*
- *Custom-cut to exact panel width for a matched fit!*

*Build it better with*

**ATLAS**  
Fasteners For Construction

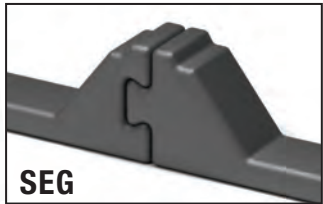
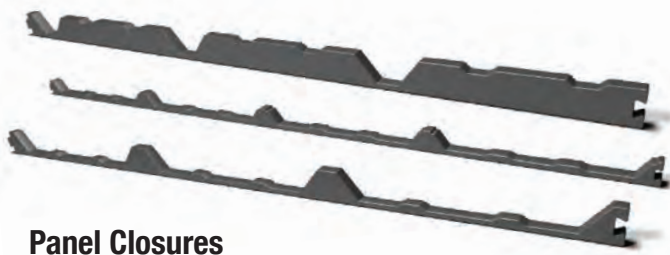
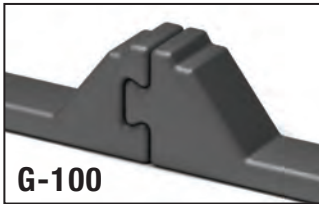

## G-100 Specifications

Material .....	Flexible cross-linked closed cell polyethylene
<b>Characteristics</b>	
Density .....	1.8 to 2.2 lbs./ft3
Service Temperature .....	-76 deg F. to +194 deg F.
Water Absorption (ASTM D-1667).....	1% volume max
Cold Crack (ASTM D1912) .....	24 hrs. @ -50 deg F. No Failures
Thermal Conductivity .....	Btu. In/hr./ft <sup>2</sup> /°F. @50° F .26 @104° F .29
<b>Thermal Stability (% shrinkage; no load)</b>	
Room Temperature .....	2%
158 deg F.....	2%
200 deg F.....	3%
RoHs.....	Compliant
<b>Strength Characteristics (ASTM D-3575)</b>	
@25% .....	5 psi
@50% .....	14 psi
Compression Set .....	28% of original thickness
Tensile Strength .....	42 psi
Elongation .....	124% to break point
Tear Resistance .....	11.5 lbs./in.
Shore Hardness (ASTM D-2240)	
OO-scale .....	55

## S-100 Specifications

Material.....	Fire Retardant, flexible cross-linked closed cell polyethylene
<b>Characteristics</b>	
Density .....	1.8 to 2.2 lbs/ft3
Service Temperature .....	-76 deg F. to +194 deg F.
Water Absorption (ASTM D-1667) .....	1% Vol (max)
Cold Crack (ASTM D-1912) .....	24 hrs. @ -50 deg F. No Failures
Thermal Conductivity .....	Btu. In/hr./ft <sup>2</sup> /°F. @50° F .26 @104° F .29
<b>Thermal Stability (% shrinkage; no load)</b>	
Room Temperature .....	1%
158 deg F.....	1%
200 deg F.....	3%
RoHs.....	Compliant
<b>Strength Characteristics (ASTM D-3575)</b>	
@25% .....	4 psi
@50% .....	13 psi
Compression Set .....	33% of original thickness
Tensile Strength.....	42 psi
Elongation .....	124% to break point
Tear Resistance .....	11.5 lbs./in.
Shore Hardness (ASTM D-2240)	
OO-scale .....	55
<b>Flammability Properties</b>	
Horizontal Burn (FMVSS-302 Motor Vehicle) .....	Pass
Vertical Burn (FAR 25.853b Aircraft) .....	Pass
UL94 for Foam Plastics .....	94HF-1 Rating
<b>ASTM E-84 / 2003 (For 1/8" thick material)</b>	
Flame Spread Index .....	5
Smoke Developed Index.....	75



[www.atlasfasteners.com](http://www.atlasfasteners.com)

1628 Troy Rd., Ashland, OH 44805, Phone: 419-289-6171, Fax: 419-289-2564

**800-321-6977**

### MANUFACTURING AND DISTRIBUTION CENTERS:

Ashland, OH	Flat Rock, NC	Houston, TX	Salem, OR
800-321-6977	800-364-0370	800-503-2105	800-547-8740

All test results and recommendations are based on laboratory tests. Specific job site conditions should be taken into consideration when specifying the proper fastener. Because applications vary, we assume no liability for use of this information.